



OPTIONS

Casing

- soft wood
- hardwood of European origin
- hard wood (oil finish)
- premium hard wood

Methods of installation

- attached by bolts to foundation

Ashtray

- include

Container

- galvanized steel container
- painted galvanized steel container

DESCRIPTION

Tubus litter bin finished with boards. Version of bin with integrated ashtray and canopy.

The structure of the bin is made of stainless steel.

Alternatively, the bin can be made of carbon steel, galvanised and powder coated in a colour chosen by the customer from the RAL palette.

The wood used in the project is softwood of European origin. It is protected by varnish, available in several colour versions. As an option, hardwood can be used at an extra charge, which is characterized by greater durability and resistance to external conditions.

The Tubus bin has been designed in such a way that it is easy to get to the inside. Inside there is a removable insert made of galvanized sheet metal of 65 L capacity. It is secured by a lockable upper part of the basket, which is tilted back when opened.

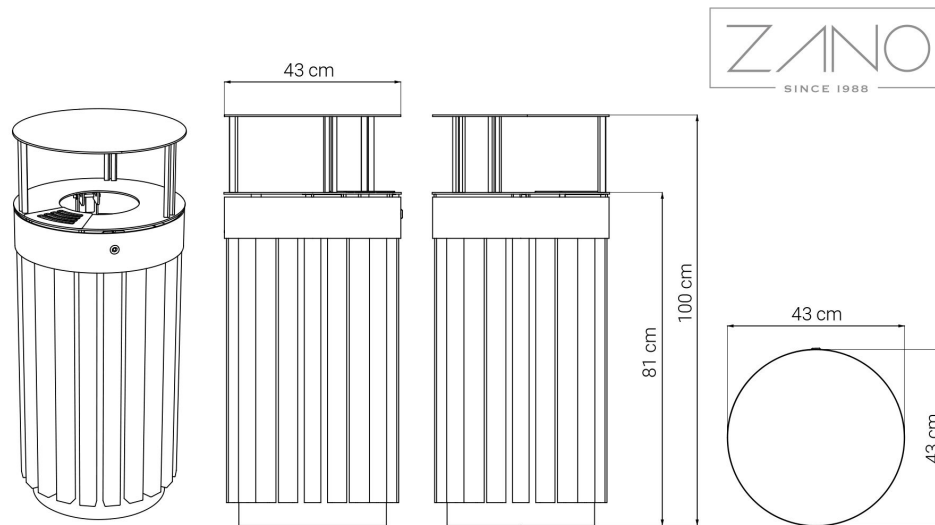

GENERAL TECHNICAL DATA

Dimensions

- width: 43 cm
- height: 100 cm
- depth: 43 cm

Capacity

- capacity: 65 l

Materials

- stainless steel or carbon steel
- insert in galvanised, powder-coated sheet metal

ZANO



Iwona Żaczek

Product:
Tubus litter bin with ashtray
Catalog number: **03.053.8**
Designer: Iwona Żaczek

In accordance with the Polish Law on Copyright and Related Rights of 04.02.1994 (Official Journal of Laws No. 24, item 83, corrected: Journal of Laws No. 43, item 170) and in accordance with the EU copyright legislation including all EU directives and regulations on copyright, Zano Mirosław Zarotynski Company, reserves the copyright of drawings, descriptions, 3D models, renderings, graphics, content contained in offers, attachments to offers and all other documents. Its content is the intellectual property of ZANO Mirosław Zarotynski company. The use of author's ideas, solutions, copying, distribution of photos, graphics or fragments of graphics, descriptive texts, for profit, without the permission of the author - ZANO Mirosław Zarotynski company - is prohibited and constitutes a copyright infringement and is punishable.

NOTE: The drawings do not reflect the actual dimensions of the foundation. They are only exemplary assembly schemes taking into account the type of anchoring and the substrate material to which the furniture is to be fixed.

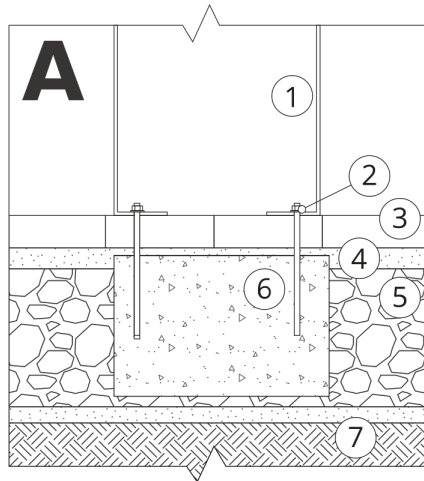
The size of the foundation depends on the local foundation conditions.



INSTALLATION INTO PAVING WITH FOUNDATION

Description of the assembly

1. ZANO product
2. Quick-action fastener or chemical anchor
3. Stone paving / concrete paving / stone slabs / concrete slabs
4. Sand ballast (approx. 2 - 4 cm)
5. Stone aggregate substructure
6. Concrete foundation, class C16/20 (top surface concrete 10 cm below paving surface)
7. Ground

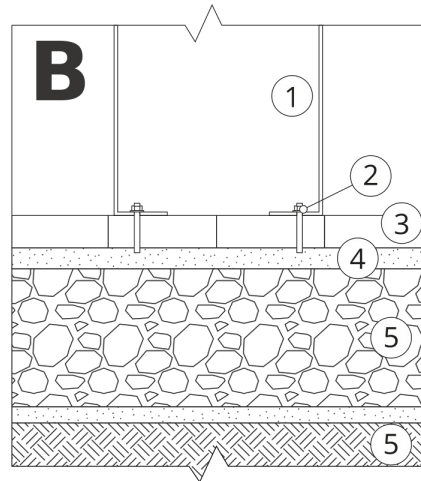

INSTALLATION TO PAVING

Description of the assembly

1. ZANO product
2. Quick-action fastener or chemical anchor
3. Stone paving / concrete paving / stone slabs / concrete slabs
4. Sand ballast (approx. 2 - 4 cm)
5. Stone aggregate substructure
6. Ground

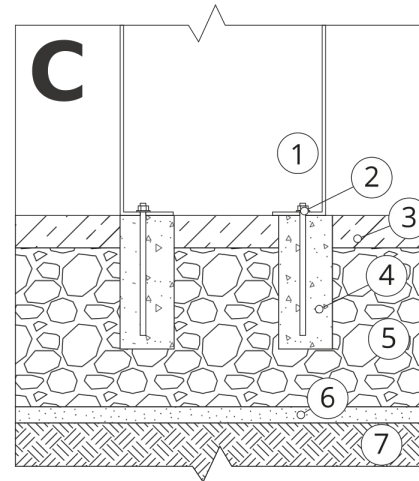

CONCRETE / ASPHALT MOUNTING

Description of the assembly

1. ZANO product
2. Quick-action fastener or chemical anchor
3. Fixed hardened surface e.g. concrete or asphalt
4. Concrete foundation, class C16/20 (top surface concrete 10 cm below paving surface)
5. Stone aggregate substructure
6. Sand ballast (approx. 2 - 4 cm)
7. Ground

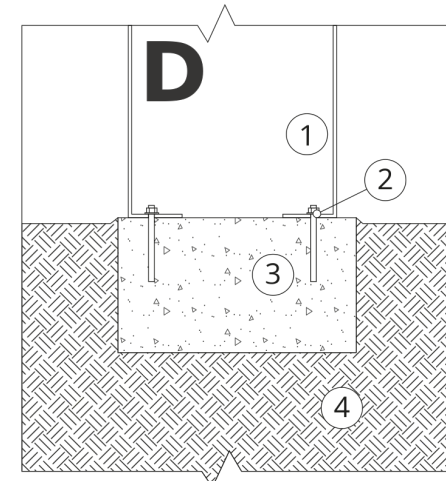

MOUNTING TO CONCRETE FOUNDATION

Description of the assembly

1. ZANO product
2. Quick-action fastener or chemical anchor
3. Concrete foundation, class C16/20 (top surface concrete 10 cm below paving surface)
4. Ground