



## OPTIONS

---

### Casing

- soft wood
- hardwood of European origin
- hard wood (oil finish)
- premium hard wood
- HPL

### Methods of installation

- attached by bolts to foundation

### Container

- galvanized steel container

## DESCRIPTION

---

**Five-chamber Flash recycling bin.** It complements the [Flash furniture line](#) with a 195 cm long basket for waste segregation. It is characterized by a characteristic, modern look of boards arranged horizontally. In addition, thanks to the [personalization](#) of the order on the boards you can find any information about the type of waste for which the bin are intended.

In each of the bin chambers there is an insert made of galvanized sheet metal. The basic wood is spruce, pine or exotic wood: iroko, sapeli or meranti. On special request, we can make the finishing of wood of any species. The wood is properly impregnated with varnish or oil, in case of exotic wood. [Varnishes and oil stains are also available here.](#) The steel used for the construction of the basket is stainless steel or optional carbon steel, galvanized and powder coated in any [RAL colour](#).

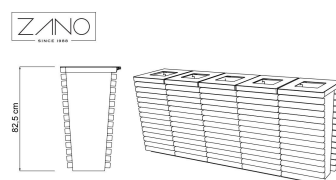
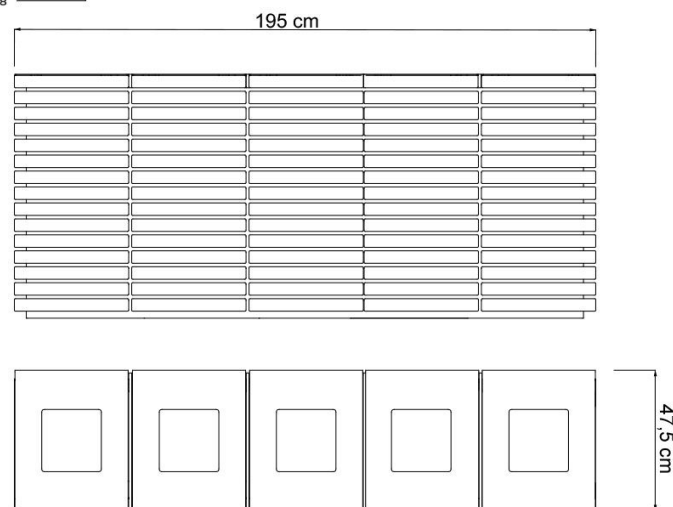

## GENERAL TECHNICAL DATA

### Dimensions

- width: 195 cm
- height: 82 cm
- depth: 48 cm

### Capacity

- number of containers: 5 pcs
- capacity of one container: 75 l

### Materials

- construction - steel, wood
- container - galvanised steel

ZANO

In accordance with the Polish Law on Copyright and Related Rights of 04.02.1994 (Official Journal of Laws No. 24, item 83, corrected: Journal of Laws No. 43, item 170) and in accordance with the EU copyright legislation including all EU directives and regulations on copyright, Zano Mirosław Zarotynski Company, reserves the copyright of drawings, descriptions, 3D models, renderings, graphics, content contained in offers, attachments to offers and all other documents. Its content is the intellectual property of ZANO Mirosław Zarotynski company. The use of author's ideas, solutions, copying, distribution of photos, graphics or fragments of graphics, descriptive texts, for profit, without the permission of the author - ZANO Mirosław Zarotynski company - is prohibited and constitutes a copyright infringement and is punishable.

**NOTE:** The drawings do not reflect the actual dimensions of the foundation. They are only exemplary assembly schemes taking into account the type of anchoring and the substrate material to which the furniture is to be fixed.

The size of the foundation depends on the local foundation conditions.

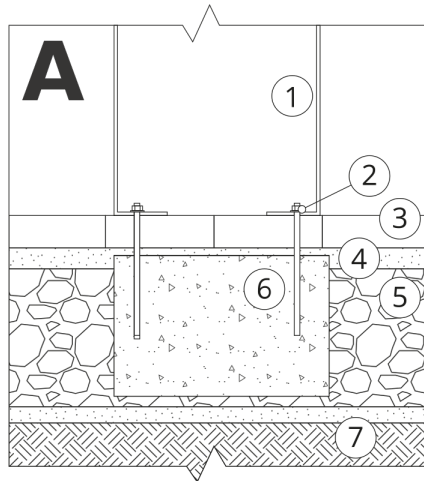

### INSTALLATION INTO PAVING WITH FOUNDATION

#### Description of the assembly

1. ZANO product
2. Quick-action fastener or chemical anchor
3. Stone paving / concrete paving / stone slabs / concrete slabs
4. Sand ballast (approx. 2 - 4 cm)
5. Stone aggregate substructure
6. Concrete foundation, class C16/20 (top surface concrete 10 cm below paving surface)
7. Ground

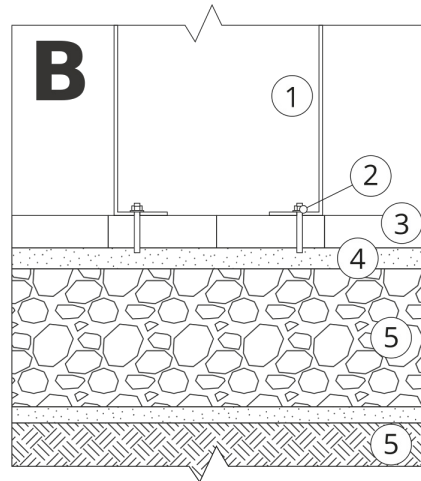

### INSTALLATION TO PAVING

#### Description of the assembly

1. ZANO product
2. Quick-action fastener or chemical anchor
3. Stone paving / concrete paving / stone slabs / concrete slabs
4. Sand ballast (approx. 2 - 4 cm)
5. Stone aggregate substructure
6. Ground

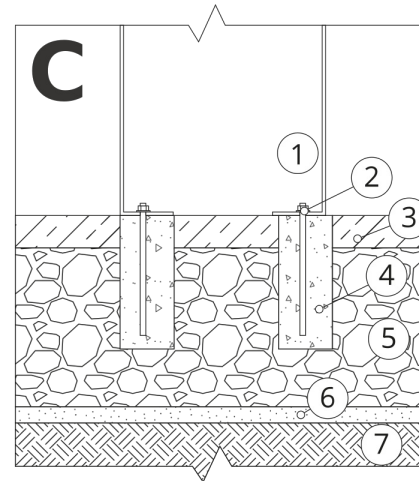

### CONCRETE / ASPHALT MOUNTING

#### Description of the assembly

1. ZANO product
2. Quick-action fastener or chemical anchor
3. Fixed hardened surface e.g. concrete or asphalt
4. Concrete foundation, class C16/20 (top surface concrete 10 cm below paving surface)
5. Stone aggregate substructure
6. Sand ballast (approx. 2 - 4 cm)
7. Ground

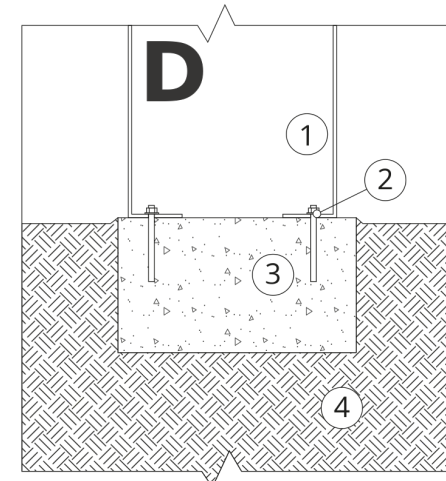

### MOUNTING TO CONCRETE FOUNDATION

#### Description of the assembly

1. ZANO product
2. Quick-action fastener or chemical anchor
3. Concrete foundation, class C16/20 (top surface concrete 10 cm below paving surface)
4. Ground